

COSTS

- 1. CHAIRS 6 PKS (4)@\$120 = \$720
- 2. SMALL TABLES 5EA 2'X4' - DONATED (FRANCIS PEOPLES)
- 3. CONFERENCE TABLE - REUSE 1 EA 2'X6' LAY ON 4'X8' BIRCH PLYWOOD \$85
- 4. TOTAL COST \$805 +TAX?
- CONTINGENCY \$195
- GRAND TOTAL \$1000

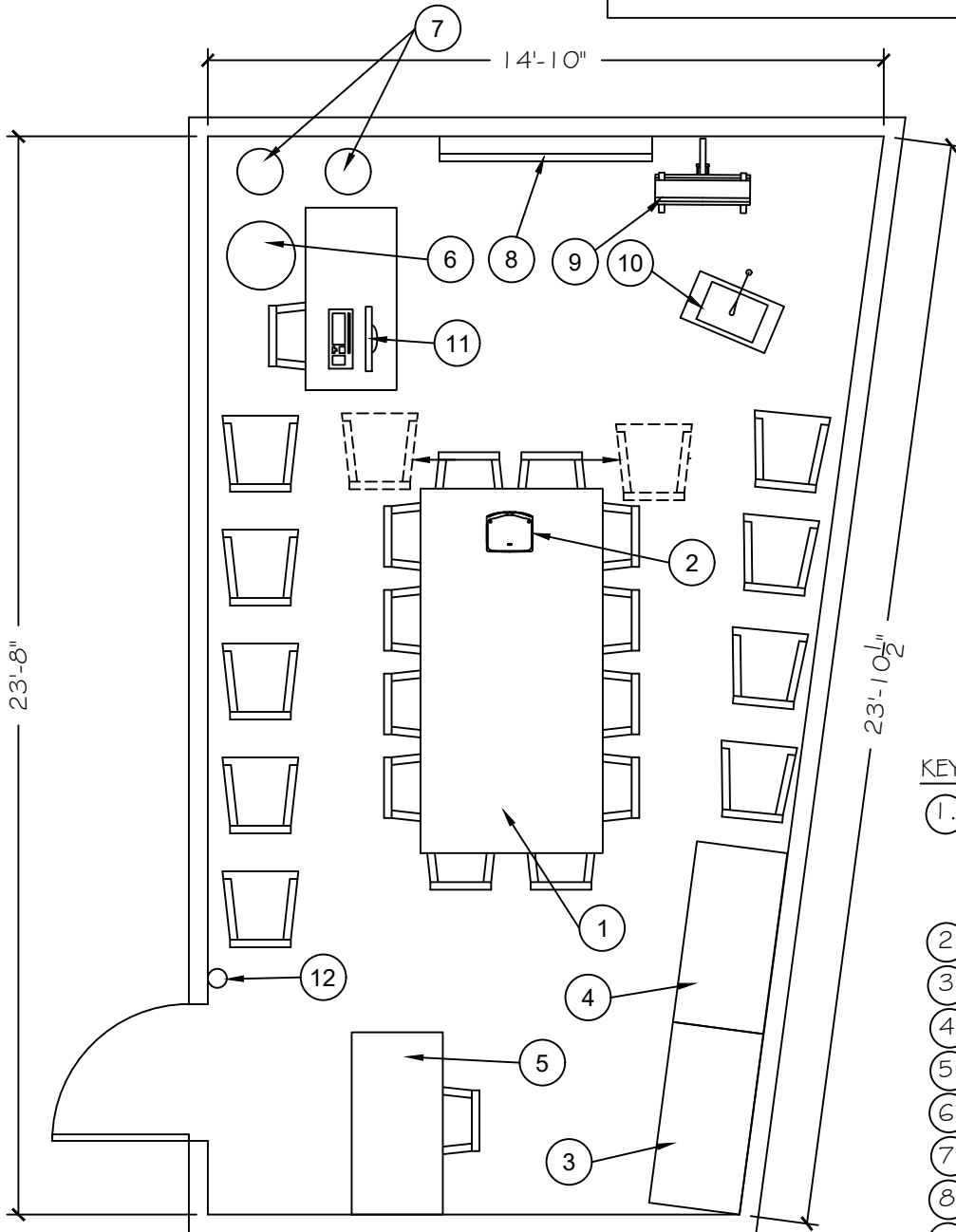

KEYED NOTES

- ① CONFERENCE ROOM TABLE (MAY NEED TO BE 42'X96")
- ② PROJECTOR
- ③ SNACK TABLE
- ④ DISPLAY TABLE
- ⑤ SIGN-IN TABLE
- ⑥ SPEAKER
- ⑦ US AND TEXAS FLAGS
- ⑧ MONITOR/SCREEN
- ⑨ EASEL
- ⑩ PODIUM
- ⑪ PROJECTOR COMPUTER
- ⑫ FIRE EXTINGUISHER

NOTE: 3 MEN 8 HRS TO PICK UP FURNITURE, EMPTY, RELOCATE, ORGANIZE AND CLEAN EXSISTING ROOM OF LARGE FURNITURE. PLACE FURNITURE, SWEEP, AND VAC. ADJUST AS NEEDED. LOCK DOOR ON WAY OUT. LABOR COSTS DONATED BY EMERY & LIZ \$600.00 PLUS LUNCH